

35 Series

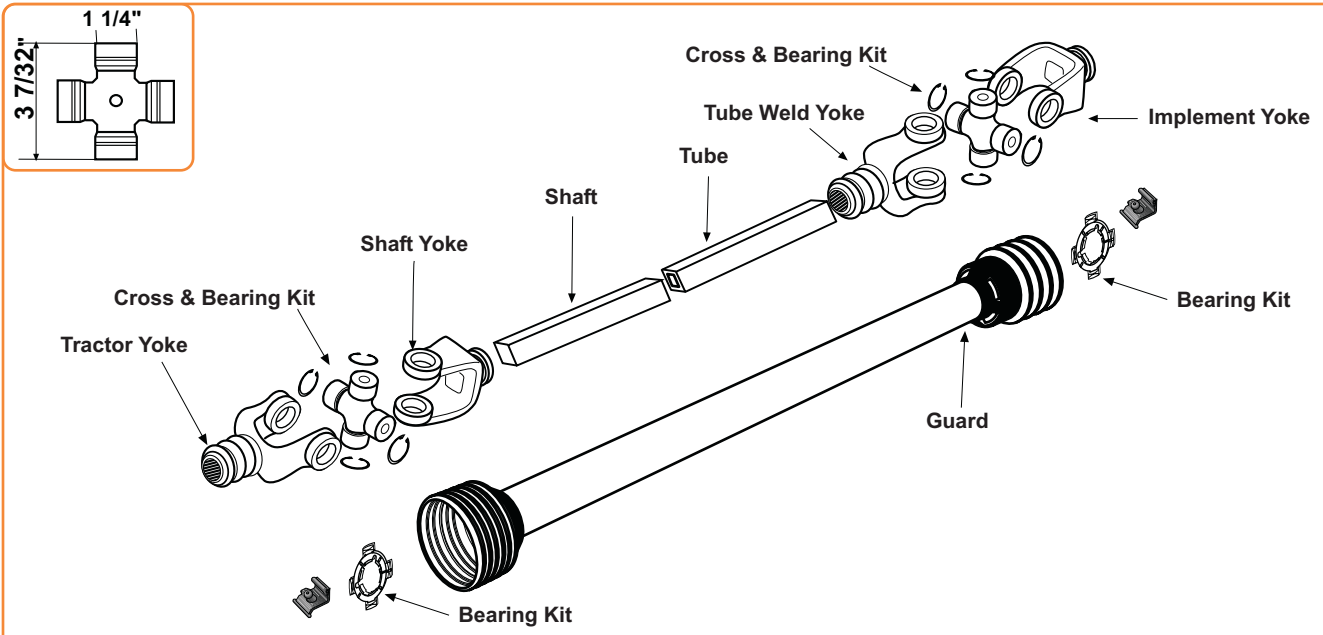

Tractor Yoke Safety Slide Lock



Stock Number	A Bore	Spline
S.101-3506	1 3/8"	6
S.101-3520	1 3/4"	20
S.101-3521	1 3/8"	21

Cross & Bearing Kit -

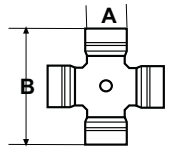

Stock Number	A	B
S.200-3500 (External)	1 1/4"	3 7/32"
S.61402 (Internal)		

Tractor Yoke Quick Disconnect

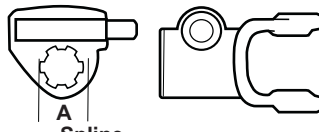

Stock Number	A Bore	Spline
S.102-3506	1 3/8"	6
S.102-3520	1 3/4"	20
S.102-3521	1 3/8"	21

Shaft Weld Yoke With Bearing Groove

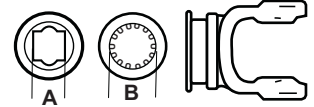

Stock Number	A Bore	B Bore	Spline
S.300-3500	1 3/16"		
S.301-3500		1 5/16"	20
S.302-3500		1 11/16"	20

Ball Shear Device With Spring-Lok

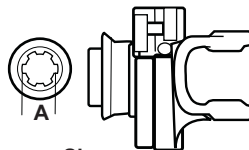

Stock Number	A Bore	Spline	Shear Bolt
S.104-3506	1 3/8"	6	3/8" - 16 Gr. 5
S.104-3521	1 3/8"	21	3/8" - 16 Gr. 5

Shaft - 1 3/16" Square

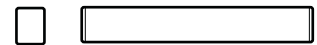

Stock Number	Length
S.400-0019	6'

35 Series

Spline Shaft

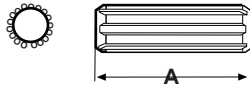

Stock Number	A Length	A Bore	Spline
S.404-2120	3'	1 5/16"	20
S.404-2720* (*Induction Hardened)	3'	1 11/16"	20

**Slip Sleeve -
13/16" Square
with Grease Groove**

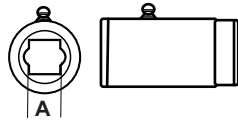

Stock Number	Length	Fits Tube Size
S.500-3500	5"	2 1/8" (.120 Wall)
S.501-3500	5"	2 1/8" (.083 Wall)

**Slip Sleeve -
With Grease
Reservoir**

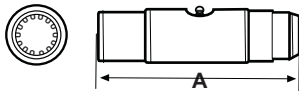

Stock Number	A Length	Bore	Spline	Fits Tube Size
S.502-3500	8"	1 5/16"	20	2 1/8" (.120 Wall)
S.503-3500	8"	1 11/16"	20	2 1/2" (.120 Wall)

Tube

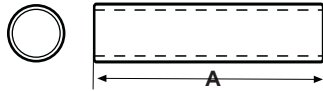

Stock Number	A Length	Fits Tube Size
S.602-3500	6'	2 1/8" (.120 Wall)
S.602-3501	6'	2 1/8" (.083 Wall)
S.70-2250	6'	2 1/4" (.120 Wall)

**Tube Weld Yoke -
with Bearing Groove**



Stock Number	A Bore
S.701-3500	2 1/8" (.120 Wall)
S.702-3500	2 1/8" (.083 Wall)
S.703-3500	2 1/4" (.120 Wall)
S.704-3500* *(Use 44 Series Guard)	2 1/2" (.134 Wall)

**Implement Yoke -
Round Bore
With Keyway &
Set Screw**

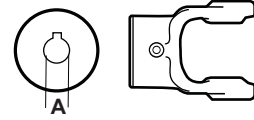

Stock Number	A Bore	Standard Keyway
S.800-3516	1"	1/4"
S.800-3518	1 1/8"	1/4"
S.800-3519	1 3/16"	1/4"
S.800-3520	1 1/4"	1/4"
S.800-3522	1 3/8"	5/16"
S.800-3523	1 7/16"	3/8"
S.800-3524	1 1/2"	3/8"
S.800-3526	1 5/8"	3/8"
S.800-3528	1 3/4"	3/8"

**Spline Bore -
With 21/64" Pin Hole**

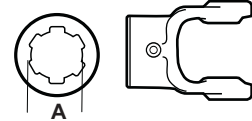

Stock Number	A Bore	Spline
S.801-3506	1 3/8"	6
S.801-3521	1 3/8"	21

**Shear Pin
With 1/4" Pin Hole**

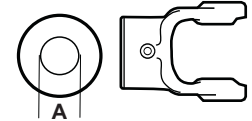

Stock Number	A Bore
S.802-3520	1 1/4"
S.802-3522*	1 3/8" (*1/4" & 1/2" Pin Hole)
S.802-3524	1 1/2"

Torque Limiter Flange

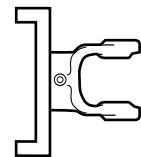

Stock Number
S.803-3500

35 Series

Square Bore With Set Screw

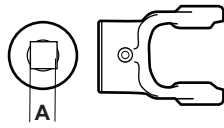

Stock Number	A Bore
S.804-3516	1"
S.804-3518	1 1/8"
S.804-3519	1 3/16"
S.804-3520	1 1/4"
S.804-3524	1 1/2"
S.804-3526	1 5/8"

Guard - Plastic Use Bearing Kit (S.22567)

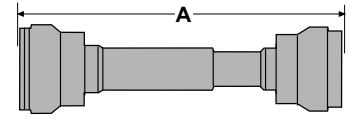

Stock Number	A Length
S.59605	29 1/2"
S.59606	39 1/2"
S.59607	51 1/2"

Round Bore Double Keyway & Set Screw

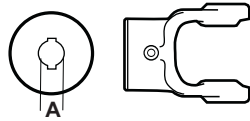

Stock Number	A Bore	Double Keyway
S.806-3520	1 1/4"	1/4" & 5/16"
S.806-3522	1 3/8"	5/16" & 3/8"

Bearing Kit - 250

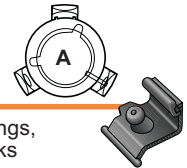

Stock Number	Kit Contains
S.22567	2 x A=52.8mm ID Bearings, 2 x S.56509 Nipple Locks

Yoke & Shaft Assembly 1 3/16" Square Shaft

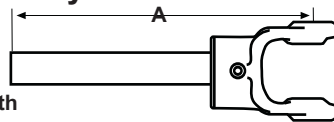

Stock Number	A Length
S.10003542	28 1/2"
S.10003548	33 1/4"
S.10003560	45"

Universal Joint - Quick Disconnect to Shaft Weld Yoke

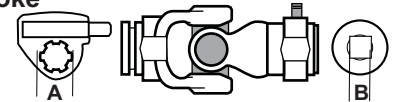

Stock Number	A Bore	B Bore
S.15063500	1 3/8" x 6	1 3/16" Square

Yoke, Tube & Sleeve Assembly 1 3/16" Square

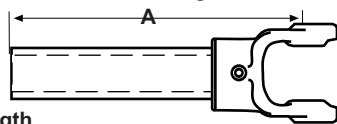

Stock Number	A Length
S.11003535	21 5/8"
S.11003548	33 1/4"
S.11003560	45"

Universal Joint - Torque Tube Weld to Implement Yoke - Round Yoke Furnished with Keyway & Set Screw

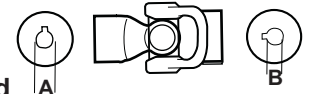

Stock Number	A Bore	B Bore
S.15003520	2 1/8" (.120 Wall)	1 1/4"
S.15003522	2 1/8" (.120 Wall)	1 3/8"
S.15003524	2 1/8" (.120 Wall)	1 1/2"

