

12 Series

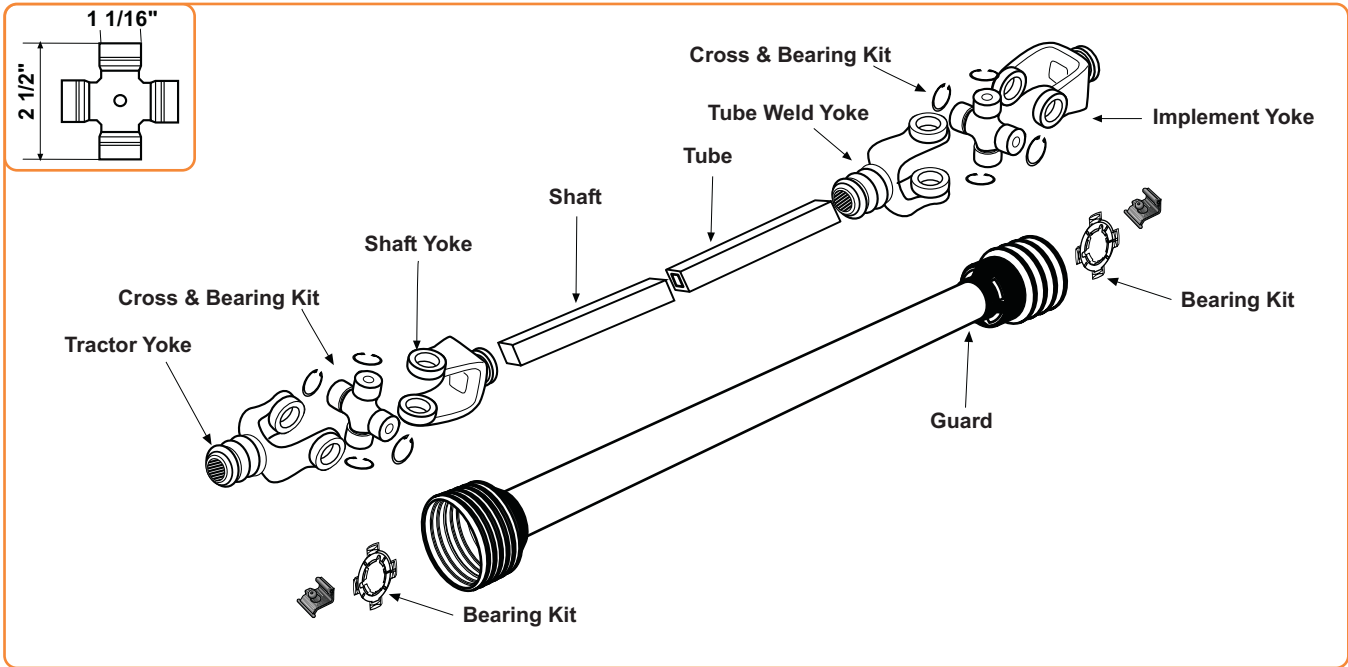

**Tractor Yoke
Spring-Lok**

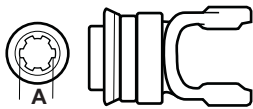

Stock Number	A Bore	Spline
S.100-1206	1 3/8"	6
S.100-1221	1 3/8"	21

**Cross & Bearing Kit
Internal Lock**

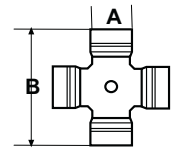

Stock Number	A	B
S.200-1200	1 1/16"	2 1/2"

**Tractor Yoke
Quick Disconnect**

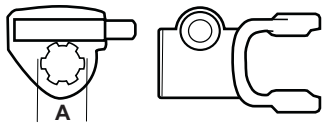

Stock Number	A Bore	Spline
S.102-1206	1 3/8"	6
S.102-1221	1 3/8"	21

**Shaft Weld Yoke
With Bearing Groove**

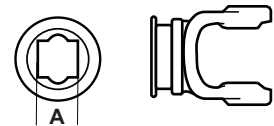

Stock Number	A Bore
S.300-1200	1" x 1 1/8"

**Ball Shear Device
With Spring-Lok**

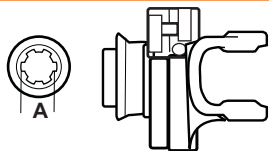

Stock Number	A Bore	Spline	Shear Bolt
S.104-1206	1 3/8"	6	5/16" - 18 Gr. 5
S.104-1221	1 3/8"	21	5/16" - 18 Gr. 5

**Shaft
1" x 1 1/8"
Rectangular**

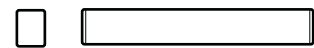

Stock Number	Length
S.400-1618	6'

12 Series

**Slip Sleeve
With Grease Groove**

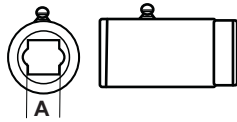

Stock Number	A Bore	Length	Fits Tube Size
S.500-1400	1" x 1 1/8" Rect.	5"	2" (.083 Wall)
S.501-1400	1 5/16" x 20 Spl.	8"	2" (.083 Wall)

**Implement Yoke -
Round Bore
With Keyway &
Set Screw**

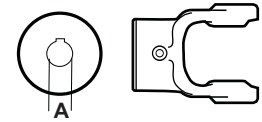

Stock Number	A Bore	Standard Keyway
S.800-1212	3/4"	3/16"
S.800-1214	7/8"	3/16"
S.800-1215	15/16"	1/4"
S.800-1216	1"	1/4"
S.800-1218	1 1/8"	1/4"
S.800-1219	1 3/16"	1/4"
S.800-1220	1 1/4"	1/4"
S.800-1222	1 3/8"	5/16"
S.800-1224	1 1/2"	3/8"

**Tube
1 1/4" x 1 3/8"
Rectangular OD**

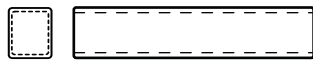

Stock Number	Length	Fits Shaft
S.600-2022	6'	1" x 1 1/8"

**Tube
2" Round**

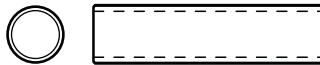

Stock Number	Length
S.602-1400	6'

**Spline Bore
With 21/64" Pin Hole**

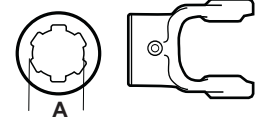

Stock Number	A Bore	Spline
S.801-1206	1 3/8"	6
S.801-1210*	1 3/16"	10 *No Pin Hole
S.801-1218	1 1/8"	6
S.801-1221	1 3/8"	21

**Tube Weld Yoke
With Bearing Groove**



Stock Number	A Bore	Fits Tube Size
S.700-1200	1 1/4" x 1 3/8"	
S.701-1200		2" (.083 Wall)

**Shear Pin
With 1/4" Pin Hole**

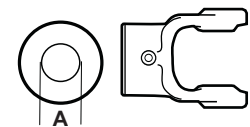

Stock Number	A Bore
S.802-1216	1"
S.802-1218	1 1/8"
S.802-1220	1 1/4"
S.802-1222	1 3/8"

**Hexagon Bore
With Set Screw**

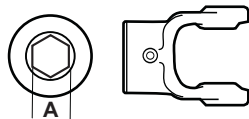

Stock Number	A Bore
S.805-1218	1 1/8"

**Square Bore
With Set Screw**

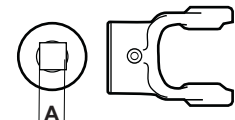

Stock Number	A Bore
S.804-1214	7/8"
S.804-1216	1"
S.804-1218	1 1/8"
S.804-1220	1 1/4"

12 Series

**Round Bore
Double Keyway &
Set Screw**

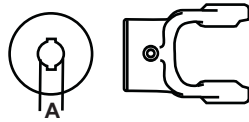

Stock Number	A Bore	Double Keyway
S.806-1216	1"	1/4" & 3/16"
S.806-1218	1 1/8"	1/4" & 5/16"
S.806-1220	1 1/4"	1/4" & 5/16"

**Universal Joint -
Tube Weld Yoke to
Implement Yoke -
Round Bore Furnished
with Keyway & Set Screw**

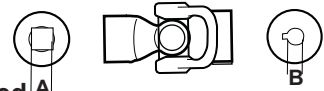

Stock Number	A Bore	B Bore
S.15001216	1 1/4" x 1 3/8"	1"
S.15001218	1 1/4" x 1 3/8"	1 1/8"
S.15001220	1 1/4" x 1 3/8"	1 1/4"

**Yoke & Shaft Assembly
1" x 1 1/8" Shaft**

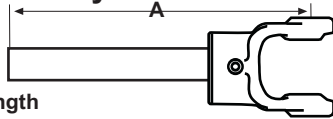

Stock Number	A Length
S.10001248	37 1/2"
S.10001260	49 1/2"

**Universal Joint - Round To Round
Furnished with Keyway & Set Screw**

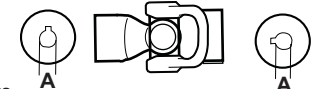

Stock Number	A Bore
S.15161216	1"
S.15201220	1 1/4"

**Yoke & Tube Assembly
1 1/4" x 1 3/8" Tube**

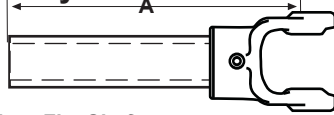

Stock Number	A Length	Fits Shaft
S.11001248	37 1/2"	1" x 1 1/8"
S.11001260	49 1/2"	1" x 1 1/8"

Bearing Kit - 250

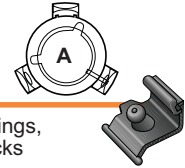

Stock Number	Kit Contains
S.22567	2 x A=52.8mm ID Bearings, 2 x S.56509 Nipple Locks

Driveline

Driveline is furnished without Cross & Bearing Kit and Implement Yoke. Select kit and Implement Yoke as required. When Cross & Bearing Kit and Implement Yoke are assembled, the overall compressed length of the driveline will be 48".

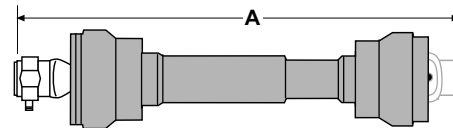

Stock Number	Tractor Yoke	Implement Yoke	A Length
S.14001248	1 3/8" x 6 Spl. Spring Lok	-	48"
S.14001220	1 3/8" x 6 Spl. Spring Lok	1 1/4" Round with 1/4" Keyway	48"

Guard - 250

Stock Number	A Length
S.59605	29 1/2"
S.59606	39 1/2"
S.59607	51 1/2"

